

HunterDouglas

Installation • Operation • Child Safety

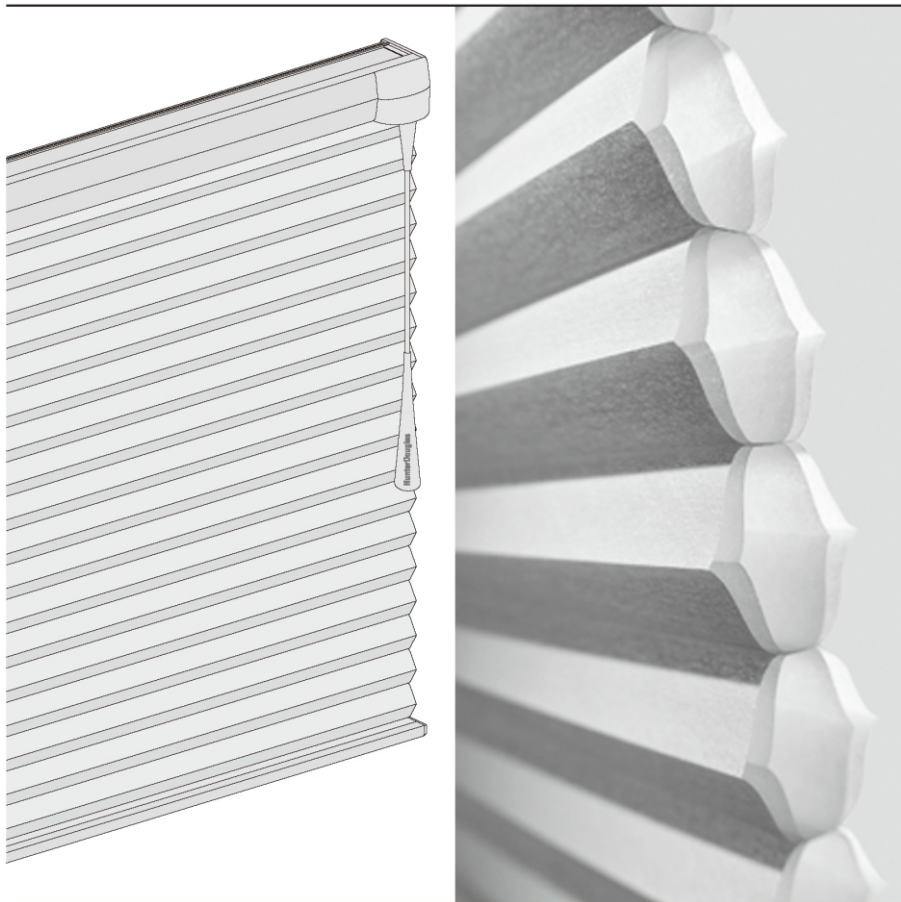

Duette[®] Honeycomb Shades
EasyRise[™] and UltraGlide[®] Lifting System

Getting Started:

Product View..... 1-2

Installation:

Installation Overview 3

Mount the Installation Brackets — Inside Mount..... 4

Mount the Installation Brackets — Outside Mount..... 5

Mount the Installation Brackets — End Mount..... 6

Install the Shade..... 7

Level the Rail(s), If Necessary..... 8

Install the Wand..... 9

Operation:

Operate the Shade..... 10-11

Troubleshooting..... 12

Child Safety:

Warning..... 13

Questions?

Call Your Local Hunter Douglas Support.

Product View EasyRise™

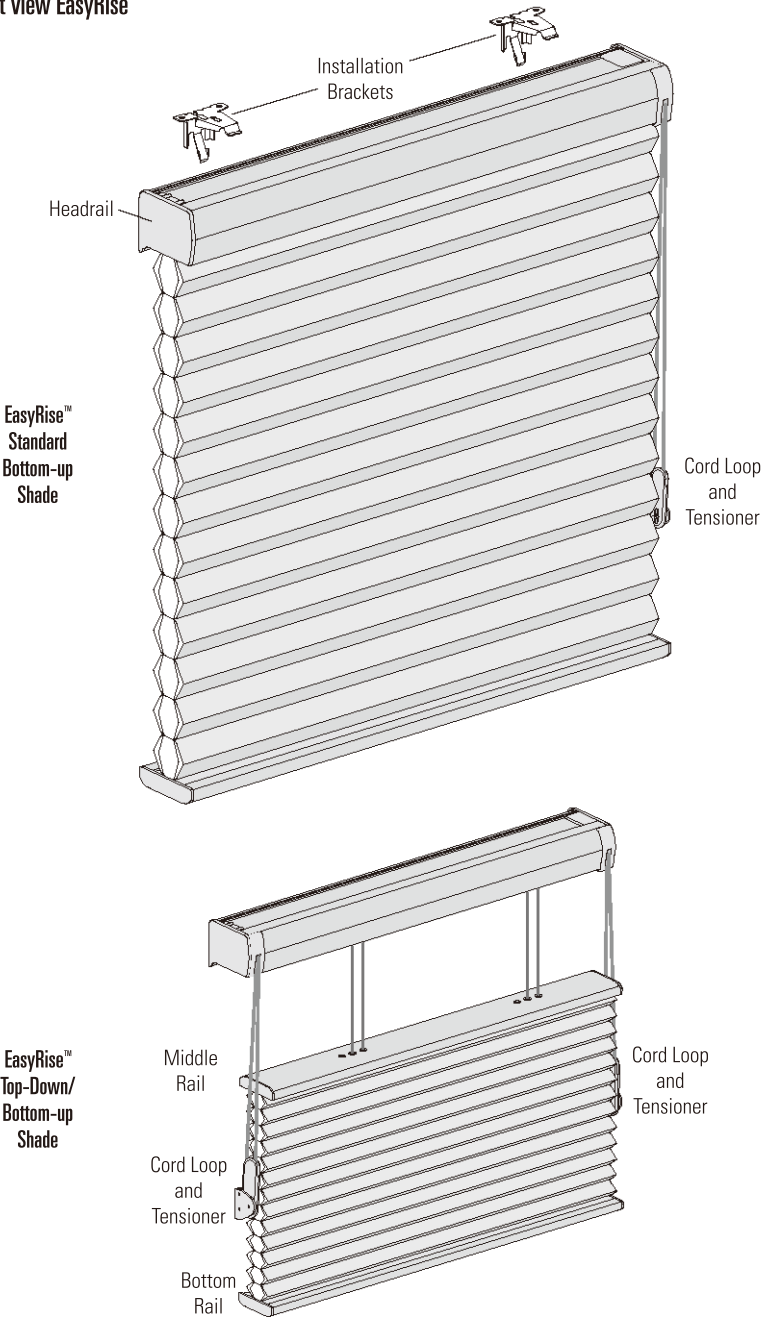

Product View UltraGlide®

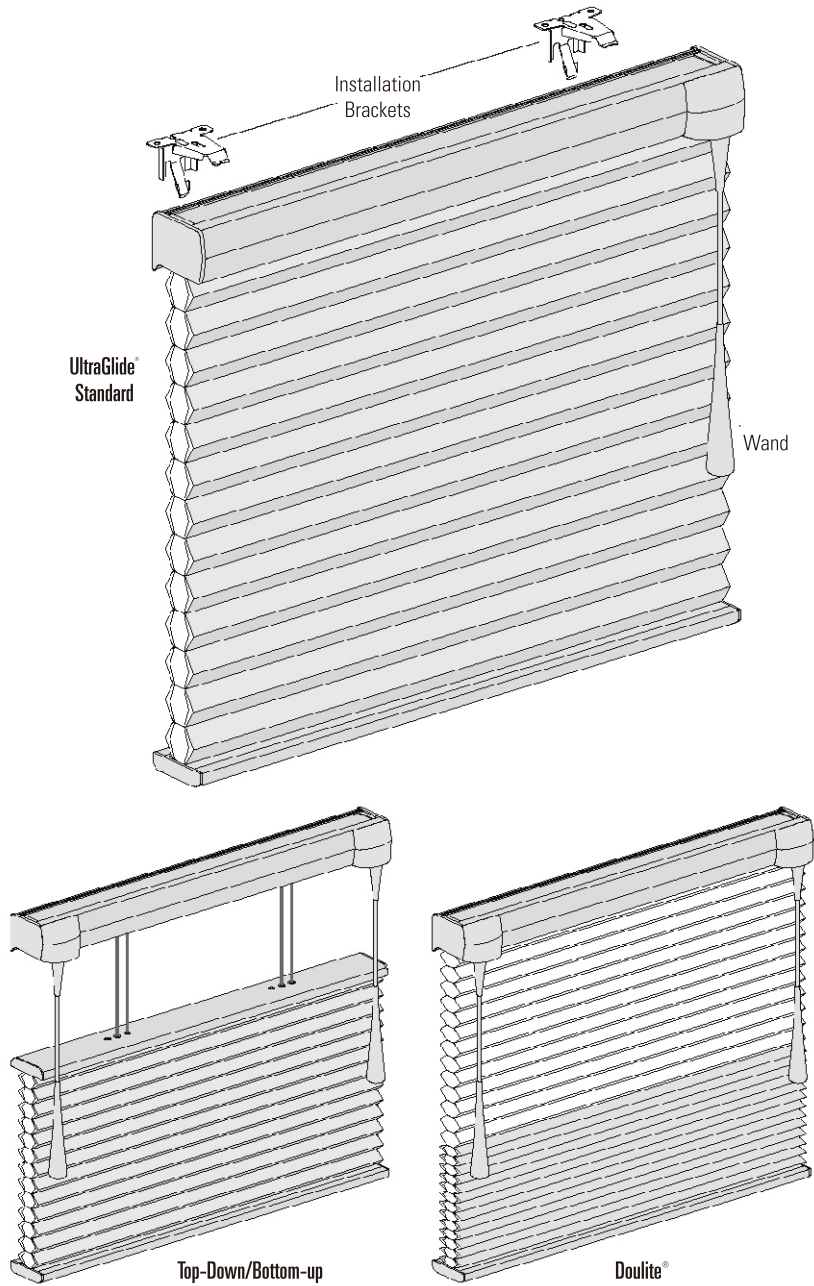

Installation Overview

- Your order will include the correct number of installation brackets for your shade width, as shown in the table.
 - There are two sizes of installation brackets, one for 3/8" and 3/4" pleat sizes and a larger one for 1 1/4" and 1 1/2" pleat sizes.

Shade Width	Brackets Required
12" – 36"	2
36 1/8" – 72"	3
72 1/8" – 108"	4
108 1/8" – 144"	5
144 1/8" – 174"	6

Mounting Types and Window Terminology

If the installation brackets are mounted correctly, the rest of the installation process follows easily. To prepare for this important first step, review the mounting types and basic window terminology illustrated below.

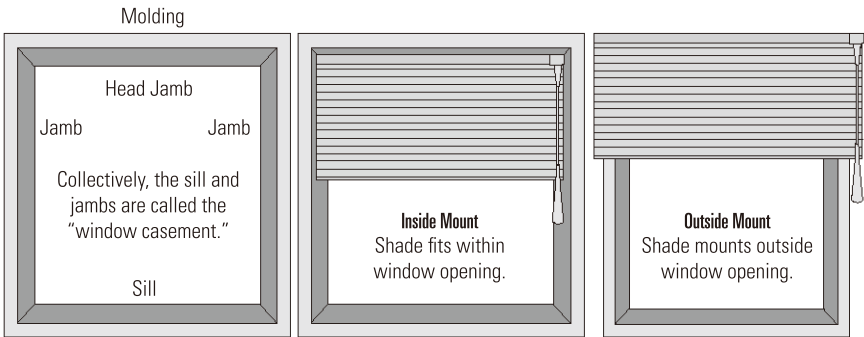

- Refer to the appropriate page below based on your order:
 - Inside Mount — Page 4
 - Outside Mount — Page 5
 - End Mount — Page 6

Mount the Installation Brackets — Inside Mount

- Measure 50mm from each jamb for bracket location.
 - If more than two installation brackets came with your order, space additional bracket(s) evenly between the two end brackets and mark their location. Mount into wood whenever possible.

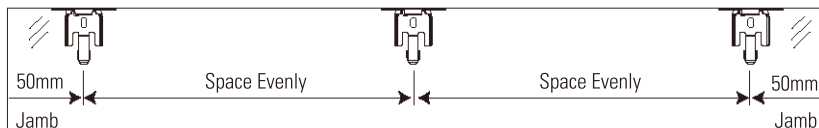

- Center the brackets on your marks, then mark the screw holes.
 - The minimum casement depth for mounting the installation brackets is 13mm. Mark both of the winged screw holes with shallow mounting depths.
 - The minimum casement depth for a fully recessed mount is 21/4" for 3/8" and 3/4" pleat sizes; 3" for 11/4" pleat size; and 31/2" for 11/2" pleat size. Mark the center screw hole when depth permits.

IMPORTANT: For 11/2" pleat size, a 1/4" rear clearance is recommended.

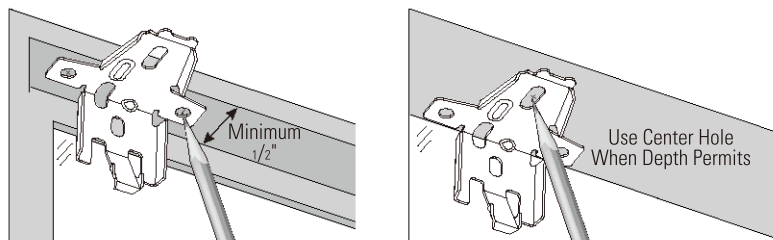

IMPORTANT: The front edges of the brackets must be level and aligned to each other.

CAUTION: Use drywall anchors when mounting into drywall.

- Use a level to check that the mounting surface is level. Shim the brackets if necessary.
- Attach the installation brackets using the screws provided.

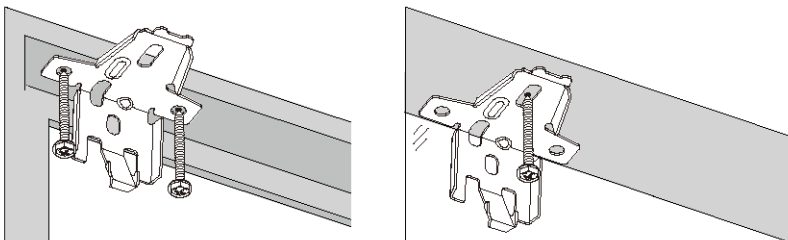

Proceed to "Install the Shade" on page 7.

Mount the Installation Brackets — Outside Mount

- Center the headrail over the window opening at the desired height. Use a pencil to lightly mark each end of the headrail on the mounting surface.
 - Alternatively, measure the width of the headrail and use that width to mark the headrail end points over the window opening.
- Mark 50mm from each end of the headrail.
 - If more than two installation brackets came with your order, space additional bracket(s) evenly between the two end brackets and mark their location. Mount into wood whenever possible.

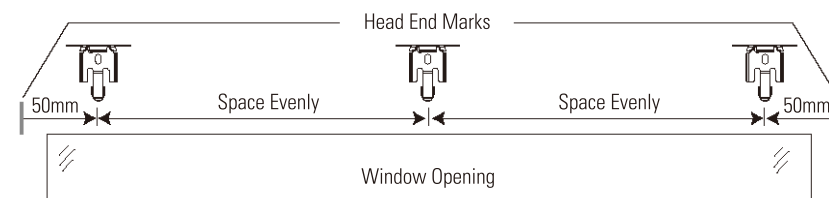

- Center the installation brackets on your marks and mark where to drill the screw holes.
 - A minimum flat vertical surface of 11/4" for installation brackets or extension brackets is required.
 - The top of the installation brackets or extension brackets should be at the desired height. The brackets should be level and aligned.
 - When using extension brackets, mark two screw holes per bracket.

CAUTION: The rear of the brackets must be flush against a flat mounting surface. Do not mount brackets on curved molding.

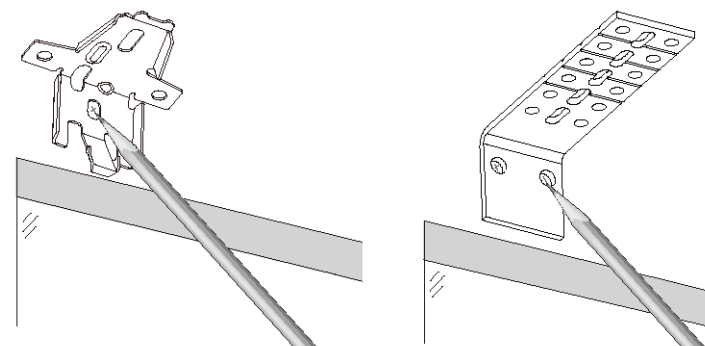

- Attach the installation or extension brackets using the screws provided.

IMPORTANT: The front edges of the brackets must be level and aligned to each other.

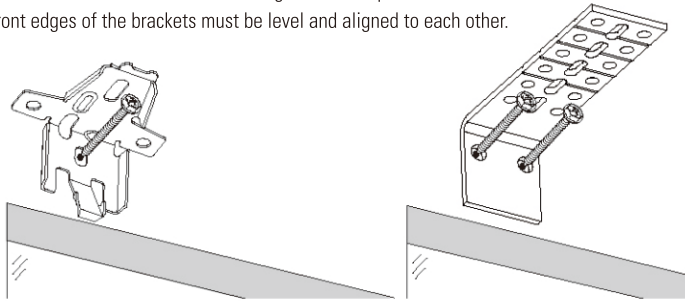

- If using spacer blocks, first attach the installation bracket to the 1/2" spacer block before stacking additional spacer blocks together.

- Insert the legs of the installation bracket into the tabs on the spacer block.
- Then rotate the installation bracket back.

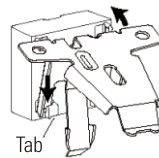

IMPORTANT: For 11/2" pleat size a 1/4" rear clearance and a minimum of 1/2" spacer block is recommended.

- Attach the spacer block and installation bracket to a flat vertical mounting surface with a #6 mounting screw long enough for a secure installation.

- A maximum of 11/2" of spacer blocks per installation bracket is recommended.
- The top of the spacer blocks should be at the desired shade height.

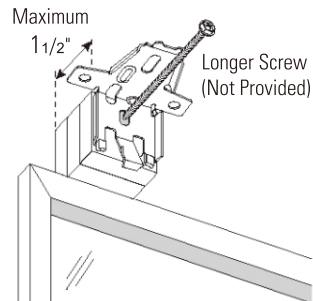

IMPORTANT: The front edges of the installation brackets must be level and aligned to each other.

CAUTION: Use drywall anchors when mounting into drywall.

- If using extension brackets, attach an installation bracket to the underside of each extension bracket using the provided screws and speed nuts.

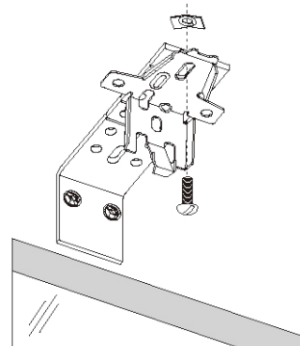

Proceed to "Install the Shade" on page 7.

Install the Shade

- Fit the front channel on top of the headrail onto the front lip of installation brackets.
- Push the headrail up and back until it snaps into place.
- Check to ensure the headrail is securely in the brackets.
 - Check that the bottom of the headrail is snapped into the base of each bracket.
 - Check that the front lip of each bracket is in the front channel of the headrail.
- If any brackets are not installed correctly, release the shade and reinstall. See "Removing the Shade, If Necessary" on page 15.

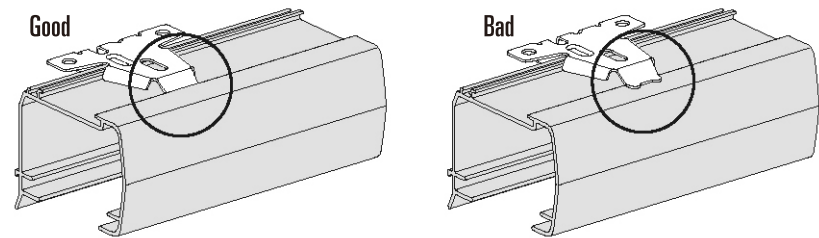
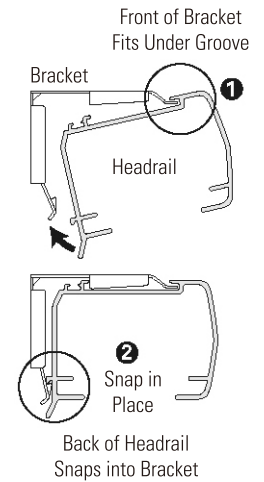

Attach the Universal Cord Tensioner(s) (Only for EasyRise™ Operation)

Before you proceed, you must first slide the cord tensioner(s) to the bottom of the cord loop.

- Insert a small screwdriver, punch, or awl through the screw hole at the bottom of the cord tensioner.
- Move the screw hole down to the indicator line to release the safety mechanism.
- Slide the cord tensioner down to the bottom of the cord loop.
- Attach the cord tensioner(s) according to the instructions provided with the *Universal Cord Tensioner Installation Kit*.

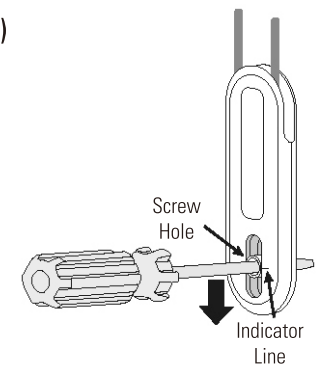

WARNING: It is imperative that the cord tensioner(s) be properly secured to the wall or window frame to reduce children's access to the cord loop. Young children can strangle in cord loops. They can also wrap cords around their necks and strangle.

CAUTION: The shade will not operate properly unless the cord tensioner(s) is secured. A Universal Cord Tensioner Installation Kit has been included with your shade. Follow the instructions in the kit to correctly secure the cord tensioner(s).

Level the Rail(s), If Necessary

- Lift the bottom rail to locate the pockets on the underside of the rail.
 - With the middle rail on Top-Down/Bottom-Up shades, the pockets are on the top side of the rail.
 - See below for the middle rail adjustment on Duolite® shades.
- Gently pull down on the bottom rail (or up on the middle rail) to fully insert the 7/64" Easy Adjust key into the pocket. The key is fully inserted when the ring on the key abuts to the pocket.
 - Lift up the rail slightly before turning the Easy Adjust key. Turn the key clockwise to raise that side of the rail, or counterclockwise to lower it.
 - One quarter turn of the key equals approximately 6mm.

IMPORTANT: The Easy Adjust key must be fully inserted to avoid stripping the mechanism. Do not pull down on the rail while turning the key.
- If there are more than two pockets, adjust the outer pockets first. Then adjust inner pockets as necessary, to maintain equal tension across the rail. As pocket adjustments are made, it is recommended that the shade be raised and lowered to check that it is level.

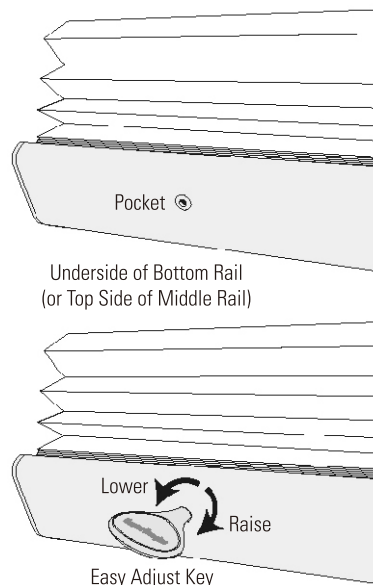

Adjusting the Duolite Middle Rail

- Hex pockets are found at the ends of the middle rail, which is located in the top cell of the lower fabric panel.
- Insert the Easy Adjust key so that its hexshaped portion is about halfway into the pocket.
- Turn the key clockwise to raise that end of the rail or counter-clockwise to lower it.
 - One full turn of the key equals approximately 3mm.
- On shades over 1500mm wide, there will be two hex pockets in the right end of the middle rail. Use the rear hex pocket to adjust the tension in the center cord after adjusting the outer cords to level the rail.

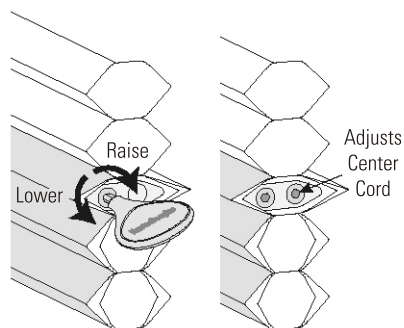

Install the Wand

The wand must be securely attached to the shade for proper operation.

- Gently pull out the bumper and threaded connector until it is visible.
- Slide the bumper away from the threaded connector.

CAUTION: Do not grip the bumper on top of the connector and attempt to screw on the wand at this point. Secure attachment of the wand cannot be guaranteed if tightened by hand.
- Hold the threaded connector with a 5/16" (8mm) open end wrench, and screw the hollow end of the wand onto the threaded connector, as shown. If necessary, pliers can be used instead of a wrench.
 - Continue to firmly rotate the wand until you feel it click two times and the wand stops moving. This ensures the wand is securely attached.

CAUTION: If the wand is not properly secured, it will come loose after repeated use.
- Slide the bumper back onto the threaded connector.
 - Make sure the bumper is properly aligned and seated tightly on top of the threaded connector.

NOTE: The underside of the bumper matches the shape on the top of the threaded connector.
- Gently release the wand.

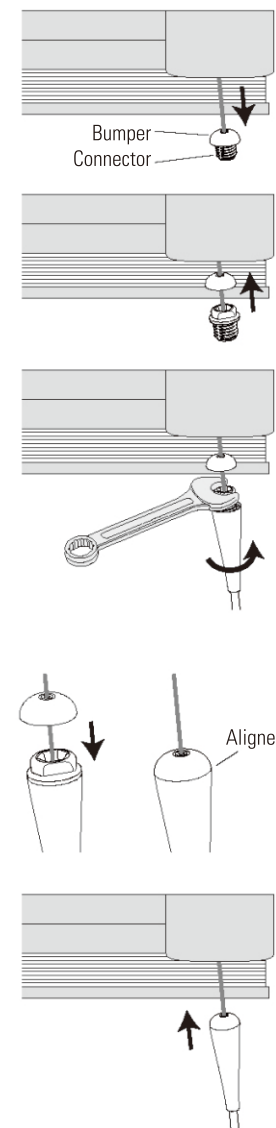

Operate the Shade

IMPORTANT: Duolite® and Top-Down/Bottom-Up shades have two operating cords. Standard Bottom-Up shades have one operating cord.

- Pull down slowly on the rear cord of the cord loop to lower the shade.
- Pull down slowly on the front cord of the cord loop to raise the shade.

IMPORTANT: If the cord tensioner moves up the cord, you have not secured it to the wall or window frame. You must do so for the shade to operate properly. See the instructions included with your *Universal Cord Tensioner Installation Kit*.

- To operate Duolite® and Top-Down/Bottom-Up shades, the right cord operates the middle rail and the left cord operates the bottom rail (unless reverse controls were specified on the order).

IMPORTANT: You must first lower the bottom rail before lowering the middle rail. Likewise, you must first raise the middle rail before raising the bottom rail.

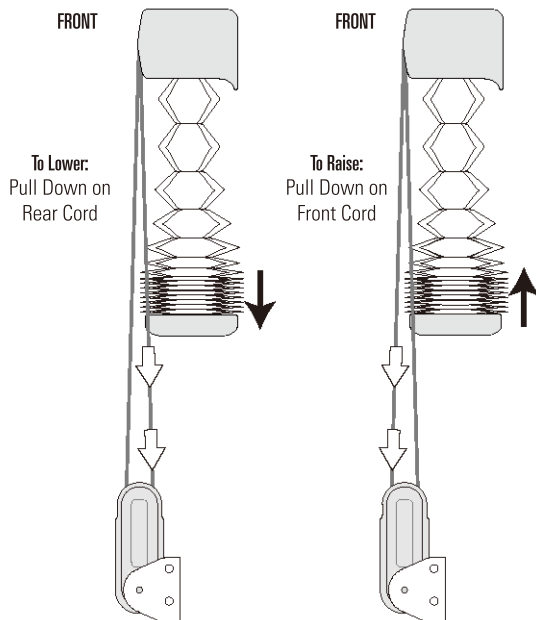
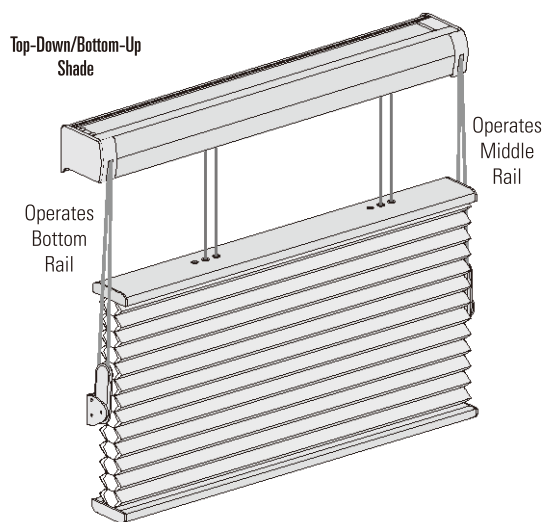

Operate the Shade

For smooth operation, keep the wand close to the fabric when raising and lowering the shade.

To Lower the Shade

- Pull the wand toward the center of the shade at about a 45° angle. The locking mechanism at the top of the wand releases with a “click.” The shade lowers as you allow the wand to return to the vertical position.

IMPORTANT: The wand must be pulled in close to the front of the shade. Do not pull the wand out away from the shade.

- To stop the shade while lowering, move the wand back toward the vertical position and give a slight downward pull to engage the locking mechanism.
- If the shade hits an obstruction as it is lowered it will stop, which may cause the cords in each cord rout to become misaligned. This may cause the shade to be angled or tilted when fully raised. If this occurs, do the following:
 - Raise the shade slightly.
 - Lower the shade completely to the sill. In some cases, pull gently on the bottom rail to get it to drop completely.

IMPORTANT: If the shade is tilted when fully raised, do not pull harder on the wand. It does not correct the tilt and may make it worse.

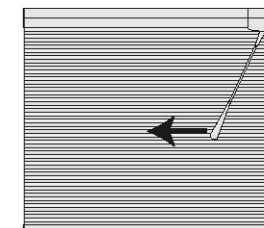

To Lower: Pull the wand toward the center of the shade and release.

To Raise the Shade

- Pull the wand straight down or slightly toward the outside.
- With each stroke the shade partially raises.
- Allow the wand to retract after each downward stroke.
- Use multiple strokes until the shade reaches the desired position.



To Raise: Pull the wand straight down with short strokes.

Duolite® and Top-Down/Bottom-Up Shades

- To operate Duolite® and Top-Down/Bottom-Up shades, the right wand operates the middle rail and the left wand operates the bottom rail (unless reverse controls were specified on the order).

IMPORTANT: You must first lower the bottom rail before lowering the middle rail. Likewise, you must first raise the middle rail before raising the bottom rail.

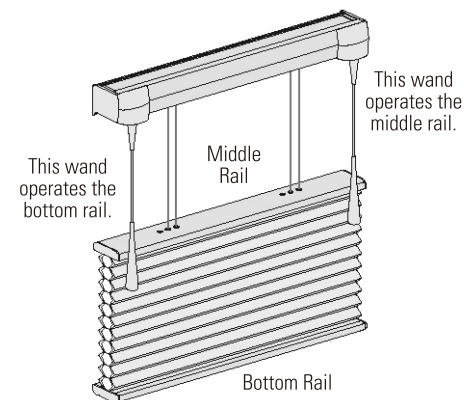

Troubleshooting

Problem	The shade will not fit into the installation brackets.
Solution	Check that the installation brackets are level and aligned. Shim the installation brackets to level the headrail, if necessary. Be sure the heads of the screws are flush against the installation bracket. Check that the headrail is completely inserted into the installation brackets. See "Install the Shade" on page 7.
Problem	The shade is hard to raise or lower, or will not raise or lower.
Solution	Check that the cord tensioner is mounted correctly. See the instructions included with your Universal Cord Tensioner Installation Kit.(EasyRise™ Only) For Duolite® and Top-Down/Bottom-Up Shades: The lift cords in the headrail may have "overturned." Try the following: <ul style="list-style-type: none"> ■ If both rails are in the raised stacked position, at the top of the window, pull down the back cord of the cord loop that operates the bottom rail. ■ With all other problems, pull down the front cord of the cord loop that operates the middle rail. Make sure that the shade fabric is not caught between the installation bracket and the headrail. Check that the headrail and installation brackets are level and aligned. Shim the installation brackets to level the headrail, if necessary. Check that cord loops are not pinched or tangled. If hold-down brackets are used, make sure they have been released before operating the shade.
Problem	The shade raises or lowers unevenly or the bottom rail is uneven when fully raised.
Solution	Lower the shade completely to allow it to "self-correct" skewing. Pull the cord loop slowly to prevent the shade from further skewing. Check that the headrail and installation brackets are level and aligned. Shim the installation brackets to level the headrail, if necessary. For Duolite and Top-Down/Bottom-Up Shades: Both the middle rail and the bottom rail may skew if the cord loop is pulled too quickly. Lower each rail completely to allow them to "self-correct." Adjust the bottom rail. See "Level the Rail(s), If Necessary" on page 12.
Problem	The universal cord tensioner has climbed to the headrail.
Solution	Pull down on the spring to relieve tension and pull the universal cord tensioner to the bottom of the cord loop. Properly mount the cord tensioner. See the instructions included with your <i>Universal Cord Tensioner Installation Kit</i> .
Problem	The universal cord tensioner grabs onto the cord upon operation.
Solution	Check that the universal cord tensioner is mounted properly. Reinstall, if necessary. See the instructions included with your <i>Universal Cord Tensioner Installation Kit</i> .



- Window Blind Cord Can STRANGLE Your Child.
- Children can climb furniture to reach cords. Move crib and furniture away.
- Keep all cords out of children's reach.

Cord Loop Shades

- Attach the cord tensioner on the cord loop to the wall or window casement. See "Attach the Universal Cord Tensioner(s)" on page 8. This can prevent children from pulling cord loops around their necks.
- Hunter Douglas provides a cord tensioner installation kit with instructions for attaching the cord tensioner. For the shade to operate properly, the cord tensioner must be correctly mounted and secured.
- Fasteners provided in this kit may not be appropriate for all mounting surfaces. Use appropriate anchors for the mounting surface conditions.
- Only Hunter Douglas supplied cord tensioners and hardware should be used. Replacement parts may be obtained by contacting your local Hunter Douglas Support.



NOTE: The warning labels on the bottom rails of corded window coverings contain important safety information. These warning labels are designed to be permanent, in accordance with the industry's safety standards, and must not be removed.



The Hunter Douglas® 2 years Quality Guarantee is an expression of our desire to provide a thoroughly satisfying experience when selecting, purchasing and living with your window fashion products.

COVERED :

- Defects in materials, workmanship or failure in assembling.
- Internal mechanisms (components and brackets).
- Repairs and/or replacements will be made with like or similar parts or products.
- Labor and transportation within 2 years guarantee.
- Motorization components are covered for 2 years from the date of purchase.

NOT COVERED :

- Any conditions caused by normal wear and tear.
- Abuse, accidents, misuse or alterations to the product.
- Exposure to the elements (sun damage, wind, water/moisture) and discoloration or fading over time.
- Failure to follow our instructions with respect to measurement, proper installation, cleaning or maintenance.

Please contact with your local dealer for warranty service.